

Space Solutions Area Focus Team



1959 -- Exhibit Hall -- Brooks Hall

A photograph of a warehouse interior filled with numerous cardboard boxes and wooden pallets, illustrating a large-scale inventory or storage area. The boxes are stacked high, some with labels like 'FILESAFE' and 'CONCRETE BLOCK MACHINES'. The warehouse has a high ceiling with industrial lighting and concrete pillars. A red and white striped border is visible on the right side of the image.

- [illegible]

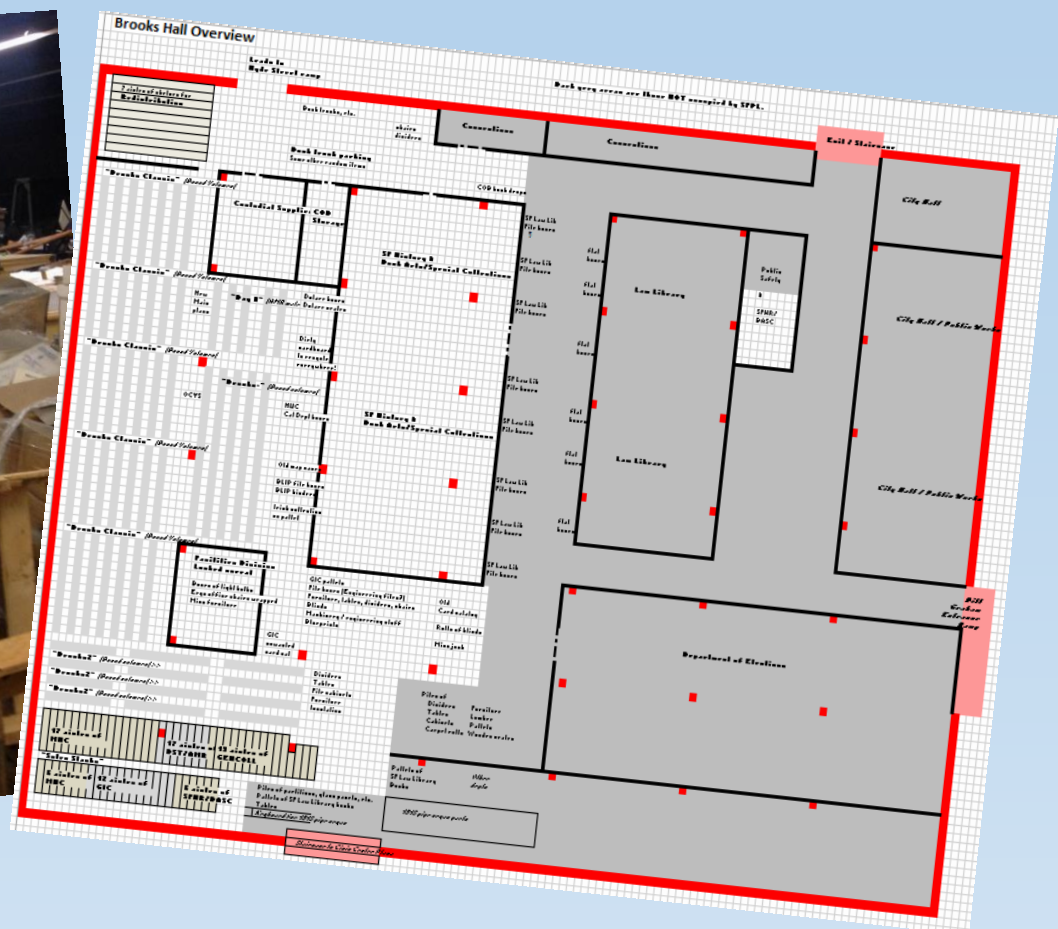

Peer Libraries Offsite Collections Audit

- Peer libraries' collection housing capacity compared
- Peer libraries' use of off-site storage surveyed
- Peer libraries' transportation and staffing for off-site storage

Systemwide collection holdings:

- **Peers:** 3.8 million items average
- **SFPL:** 3.1 – 3.5 million items, including Brooks

SFPL Main Library capacity for housing collections:

- Below median, but we also have 190 and Brooks (or alternative)

Conclusion from peer survey: SFPL, including Brooks Hall space and 190 Ninth, has median-level collection housing capacity. Room for improvement: conditions: security, environmental controls.

Collection Maintenance Review

Collection Levels in SFPL's Collection Development Plan

- **Basic Collection**
- **Support Collection**
- **Resource Collection**
- **Comprehensive Collection**

Next Steps for Librarian Staff

- Use available collection maintenance tools: Createlists, CollectionHQ, MNC use statistics, tools to check availability online and through ILL/Link+
- Managers and selectors work together:
 - BEFORE MOVE: Review collection to avoid costs, time, and effort of moving material that doesn't fit with our Collection Development Plan.
 - AFTER MOVE: Continued need to manage growth according to Collection Development Plan.

750 Brannan Street



750 Brannan Street

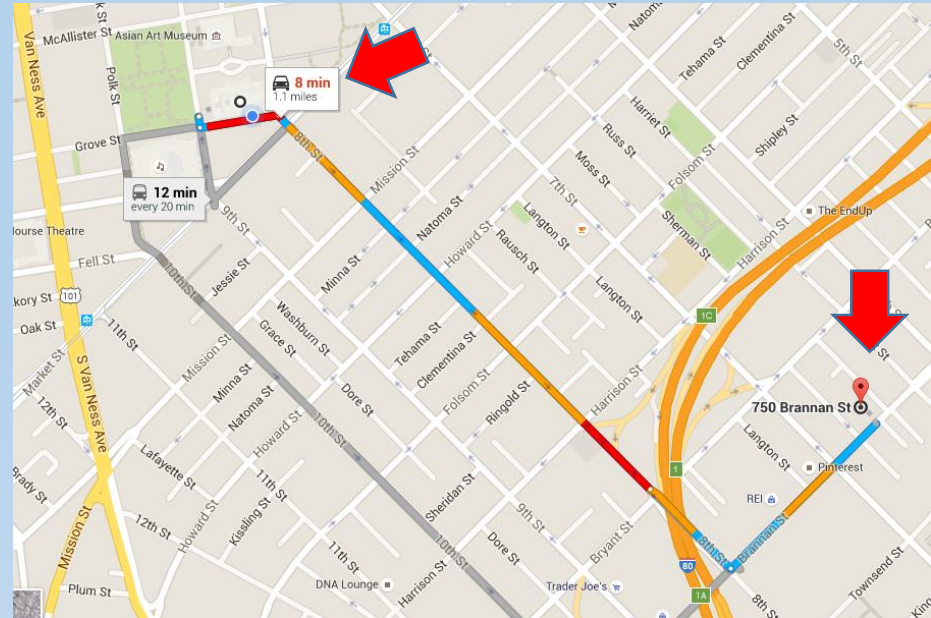

- Well maintained and secure facility
- 1.1 miles from Main Library
- Bookmobile parking and office space
- Loading docks
- High ceilings for enhanced storage
- Concrete floors to support compact shelving
- Conditioned space for archival storage

Next Steps for Facilities

- Lease review and approval by City Attorney's Office, Summer 2016
- BOS Budget and Finance hearing and approval, Summer 2016
- Full Board of Supervisors hearing and approval, Fall 2016